

Installation manual

**W475H/N/S, W485N/S, W4105H/N/S,
W4130H/N/S, W4180H/N/S, W4240H/N/S,
W4250N/S, W4300H, W4330N/S**

Compass Control

Thinking of you

 **Electrolux**

SAFETY AND WARNINGS SIGNS

Replace If Missing Or Illegible

One or more of these signs must be affixed on each machine as indicated, when not included as part of the front instruction panel.

LOCATED ON THE OPERATING INSTRUCTION SIGN OF THE MACHINE:

CAUTION

1. Do not attempt to open door until "Door unlocked" indicator is lit.
2. Machine must not be used by children.
3. Do not use flammable liquids in this machine.

MACHINE MUST NOT BE USED BY CHILDREN

WARNING: ALL OPERATING AND MAINTENANCE PROCEDURES SHOWN ON THE NEXT PAGE OF THIS MANUAL MUST BE FOLLOWED DAILY FOR PROPER OPERATION OF YOUR MACHINE.

PLEASE ENTER THE FOLLOWING INFORMATION AS IT APPEARS ON THE MACHINE(S) DATA PLATE(S).

MACHINE TYPE OR MODEL	
MACHINE SERIAL NUMBER(S)	
ELECTRICAL CHARACTERISTICS: _____ VOLTS, _____ PHASE, _____ HZ.	

MAKE CERTAIN TO KEEP THIS MANUAL IN A SECURE PLACE FOR FUTURE REFERENCE.



IMPORTANT SAFETY INSTRUCTIONS

WARNING -

To reduce the risk of fire, electric shock, or injury to persons when using your appliance:

1. Read all instructions before using the appliance.
2. This machine must be securely bolted to the floor according to the installation instructions.
3. This machine **MUST** be serviced and operated in compliance with manufacturers instructions. **CHECK DOOR LOCKS EVERY DAY FOR PROPER OPERATION TO PREVENT INJURY OR DAMAGE. IF THE DOOR LOCK FAILS TO OPERATE PROPERLY, PLACE THE MACHINE OUT OF ORDER UNTIL THE PROBLEM IS CORRECTED.**
4. Do not wash articles that have been previously cleaned in, washed in, soaked in, or spotted with gasoline, drycleaning solvents, or other flammable or explosive substances, as they give off vapors that could ignite or explode.
5. Do not add gasoline, dry-cleaning solvents, or other flammable or explosive substances to the wash water. These substances give off vapours that could ignite or explode.
6. Under certain conditions, hydrogen gas may be produced in a hot-water system that has not been used for 2 weeks or more. **HYDROGEN GAS IS EXPLOSIVE.** If the hot-water system has not been used for such a period, before using a washing machine, turn on all hot-water faucets and let the water flow from each for several minutes. This will release any accumulated hydrogen gas. As the gas is flammable, do not smoke or use an open flame during this time.
7. Do not allow children to play on or in the appliance. Close supervision of children is necessary when the appliance is used near children.
8. Before the appliance is removed from service or discarded, remove the door.
9. Do not reach into the appliance if the tube is moving.
10. Do not install or store this appliance where it will be exposed to the weather.
11. Do not tamper with controls.
12. Do not repair or replace any part of the appliance or attempt any servicing unless specifically recommended in the user-maintenance instructions or in published user-repair instructions that you understand and have the skills to carry out.

NOTICE TO: OWNERS, OPERATORS AND DEALERS

IMPROPER INSTALLATION AND INADEQUATE MAINTENANCE, POOR HOUSEKEEPING AND WILLFUL NEGLIGENCE OR BYPASSING OF SAFETY DEVICES MAY RESULT IN SERIOUS ACCIDENTS OR INJURY.

TO ASSURE THE SAFETY OF CUSTOMERS AND/OR OPERATORS OF YOUR MACHINE, THE FOLLOWING MAINTENANCE CHECKS MUST BE PERFORMED ON A DAILY BASIS.

1. Prior to operation of the machine, check to make certain that all operating instructions and warning signs are affixed to the machine and legible. Missing or illegible ones must be replaced immediately. Be sure you have spare signs and labels available at all times. These can be obtained from your dealer.
2. Check the door safety interlock, as follows:
 - (a) OPEN THE DOOR of the machine and attempt to start in the normal manner:
For coin-operated models, insert the proper coins to start the machine.
For manually operated models, place the ON-OFF switch in the ON position and press the Start switch.

THE MACHINE(S) MUST NOT START !

- (b) CLOSE THE DOOR to start machine operation and, while it is operating, attempt to open the door without exerting extreme force on the door handle. The door should remain locked!

If the machine can start with the door open, or can continue to operate with the door unlocked, the door interlock is no longer operating properly. The machine must be placed out of order and the interlock immediately replaced. (See the door interlock section of the manual.)
3. DO NOT UNDER ANY CIRCUMSTANCES ATTEMPT TO BYPASS OR REWIRE ANY OF THE MACHINE SAFETY DEVICES AS THIS CAN RESULT IN SERIOUS ACCIDENTS.
4. **Be sure to keep the machine(s) in proper working order:** Follow **all** maintenance and safety procedures. Further information regarding machine safety, service and parts can be obtained from your dealer.

All requests for assistance must include the model, serial number and electrical characteristics as they appear on the machine identification plate. Insert this information in the space provided on the previous page of this manual.
5. **WARNING:** DO NOT OPERATE MACHINE(S) WITH SAFETY DEVICES BYPASSED, REWIRED OR INOPERATIVE! DO NOT OPEN MACHINE DOOR UNTIL DRUM HAS STOPPED ROTATING!

NOTICE TO INSTALLER

Improper installation of this machine:

- May cause serious damage to the machine.
- May result in other property damage.
- May cause personal injury.
- Will void the manufacturer's warranty.

Improper fastening of this machine to its foundation, inferior foundation materials, an undersized foundation, the use of fabricated steel bases not provided by Electrolux or its approved supplier(s), the use of an improper type, number, or size of mounting bolts, or failure to use proper hardware on mounting bolts may result in damage to the machine that will not be covered by the manufacturer's warranty.

Use of a steel base beneath this machine **DRAMATICALLY INCREASES** the mechanical stress placed on the underlying concrete floor or foundation. This must be taken into consideration when employing a steel base to raise the height of the machine.

The use of steel bases more than six inches in height is **NOT** recommended. If installation requires a base higher than six inches, contact Electrolux Technical Support for advice.

Connection to line Voltage or over-current protection devices other than those specified on the data plate may result in severe damage to machine components, and will void the manufacturer's warranty.

Refer to complete installation instructions provided in manuals accompanying the machine.

Contact Electrolux Technical Support with any questions BEFORE installing this machine. Damage resulting from inadequate installation materials or improper installation techniques will void the manufacturer's warranty.

Contents

Contents

Safety precautions	9
Technical data.....	11
Installation W475H-W4330H.....	19
Transportation and unpacking, W475H, W4105H	19
Transportation and unpacking, W4130H-W4300H	20
Siting and floor	21
Mechanical installation	22
Installation W485N/S-W4330N/S.....	23
Siting	23
Floor	23
Casting a plinth	24
Installing the machine	26
Water connections	27
Drain connection	29
Steam connection	30
Connection of external liquid supplies	31
Functions for I/O-cards	34
Electrical installation.....	35
Function checks.....	41

The manufacturer reserves the right to make changes to design, material and/or specifications without notice.

Safety Precautions



Safety Precautions



The machine is designed for water washing only.

The machine must not be used by children.

All installation operations are to be carried out by qualified personnel. Licensed personnel are necessary for all electric power wiring and plumbing

Do not hose down the machine with water.

The door interlock must be checked daily for proper operation and must not be bypassed.

All seepage in the system, due to faulty gaskets etc., must be repaired immediately.

All service personnel must be fully familiar with the operating manual before attempting any repair or maintenance of the machine

The machine must not be sprayed with water

Do not add flammable or explosive substances to the wash water. There may give off vapors that could ignite or explode

The machine is not intended to be used by people (including minors) with reduced physical or mental capacity or lack of experience and knowledge. Such people must be instructed in the use of the machine by a person who has responsibility for their safety. Minors must be supervised to ensure that they do not play with the machine.



All external equipment which is connected to the machine must be CE/EMC-approved and connected using an approved shielded cable.



1	Electrical connection
2	Cold water
3	Hot water
4	Hard water (option)
5	Steam connection
6	Drain
7	Liquid detergent supply
8	Control panel
9	Soap box
10	Door opening, W475H: \varnothing 310 mm/12 3/16", W4105H: \varnothing 365 mm/14 3/8", W4130H: \varnothing 395 mm/15 9/16", W4180H, W4240H, W4300H: \varnothing 435 mm/17 1/8"

	A	B	C	D	E	F	G	H	I	K	L	M	N	O	P	R	S
W475H	720	690	1115	355	720	825	45	1030	220	1010	135	910	830	360	100	240	–
W4105H	830	705	1300	365	740	910	45	1115	220	1095	135	995	910	415	100	295	–
W4130H	910	785	1325	435	825	1035	125	1245	215	1225	300	1125	–	–	100	305	455
W4180H	970	870	1410	470	945	1120	115	1330	230	1290	315	1205	370	410	100	335	485
W4240H	1020	915	1445	500	955	1155	100	1360	215	1320	300	1240	350	360	100	360	510
W4300H	1020	1060	1445	500	1135	1155	100	1360	215	1320	300	380	–	–	100	360	335

W475H, W4105H, W4130H

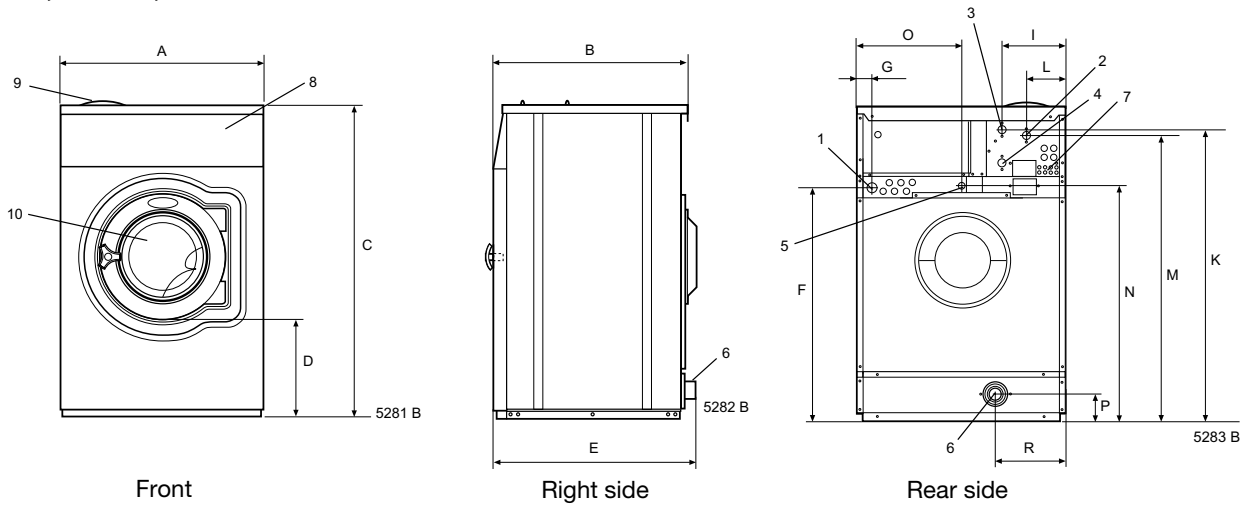

W4180H, W4240H, W4300H

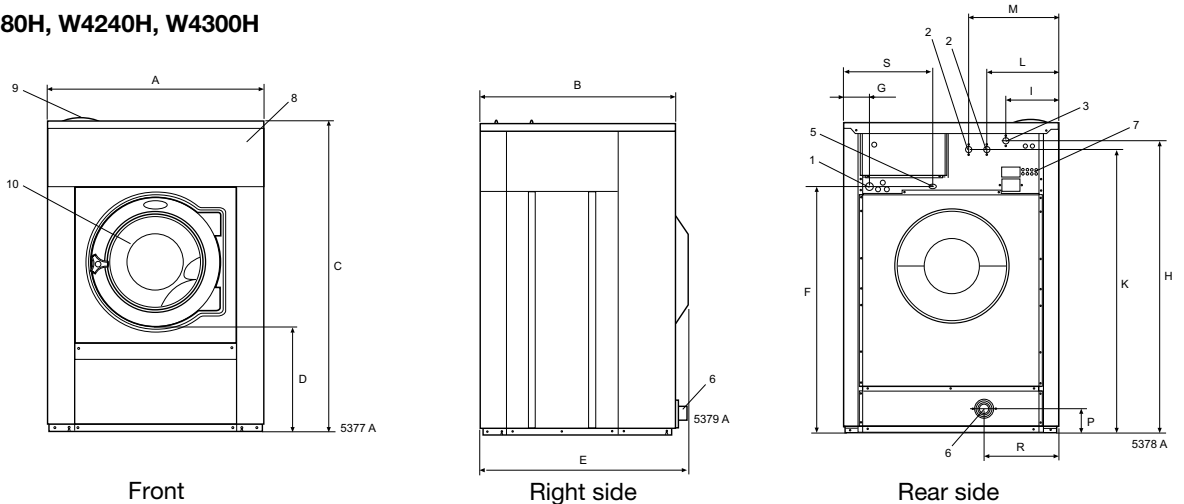

Technical data

in inch	A	B	C	D	E	F	G	H	I	K
W475H	28 3/8	27 3/16	43 7/8	14	28 3/8	32 1/2	1 3/4	40 9/16	8 11/16	39 3/4
W4105H	32 11/16	27 3/4	51 3/16	14 3/8	29 1/8	35 13/16	1 3/4	43 7/8	8 11/16	43 5/16
W4130H	35 13/16	30 7/8	52 3/16	17 1/8	32 1/2	40 3/4	4 15/16	49	8 7/16	48 1/4
W4180H	38 3/16	34 1/4	55 1/2	18 1/2	37 3/16	44 1/8	4 1/2	52 3/8	9 1/16	50 13/16
W4240H	40 3/16	36	56 7/8	19 11/16	37 5/8	45 1/2	3 15/16	53 9/16	8 7/16	51 15/16
W4300H	40 3/16	41 3/4	56 7/8	19 11/16	44 11/16	45 1/2	3 5/16	53 9/16	8 7/16	51 15/16

in inch	L	M	N	O	P	R	S
W475H	5 5/16	35 13/16	32 11/16	14 3/16	3 5/16	9 7/16	-
W4105H	5 5/16	39 3/16	35 13/16	16 5/16	3 5/16	11 5/8	-
W4130H	11 13/16	44 5/16	-	-	3 5/16	12	17 15/16
W4180H	12 3/8	47 7/16	14 9/16	16 1/8	3 5/16	13 3/16	19 1/8
W4240H	11 13/16	48 13/16	13 3/4	14 15/16	3 5/16	14 3/16	20 1/16
W4300H	12 3/16	14 15/16	-	-	3 15/16	14 3/16	13 3/16

W475H, W4105H, W4130H

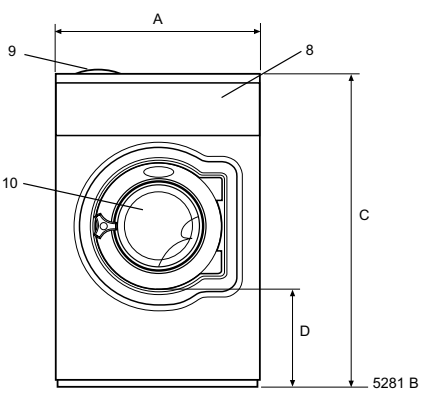

Front

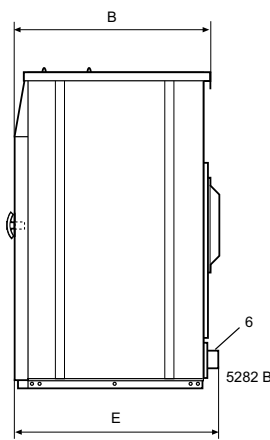

Right side

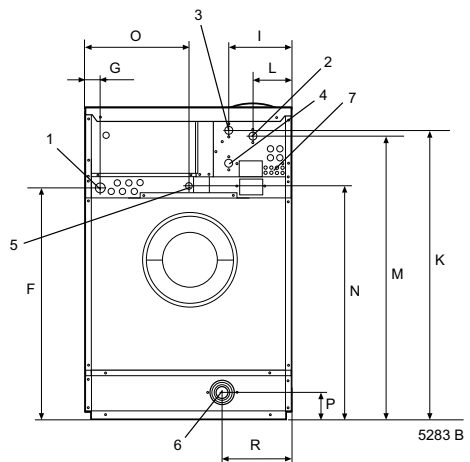

Rear side

W4180H, W4240H, W4300H

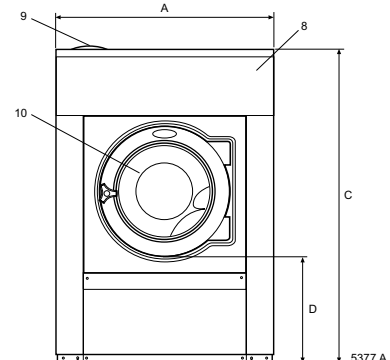

Front

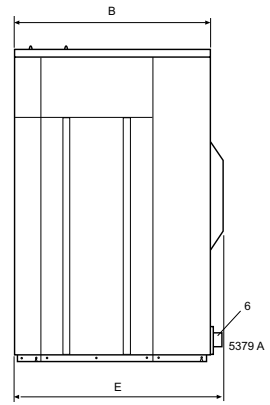

Right side

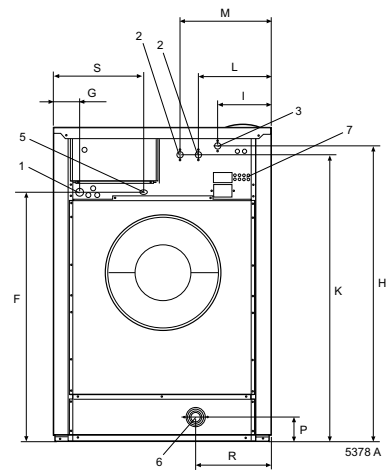

Rear side

1	Electrical connection
2	Cold water
3	Hot water
4	Steam connection
5	Drain
6	Liquid detergent supply
7	Control panel
8	Soap box
9	Water reuse
10	Door opening, W485S: \varnothing 310 mm/12 3/16", W4105S, W4130S: \varnothing 365 mm/14 3/8", W4180S: \varnothing 395 mm/15 9/16", W4250S, W4330S: \varnothing 435 mm/17 1/8"

	A	B	C	D	E	F	G	H	I	K	L	M	N	O	P	R
W485N/S	660	730	1115	355	765	825	45	1030	215	1010	130	830	385	-	100	225
W4105N/S	720	705	1200	365	740	910	45	1115	215	1095	130	910	420	-	100	235
W4130N/S	720	790	1200	365	825	910	45	1115	215	1095	130	910	420	-	100	235
W4180N/S	750	880	1325	435	915	1035	45	1245	130	1225	210	1040	325	295	100	225
W4250N/S	830	955	1410	470	990	1120	45	1330	160	1290	245	1125	325	325	100	265
W4330N/S	910	1040	1445	500	1075	1155	45	1365	160	1325	245	1155	280	325	100	210

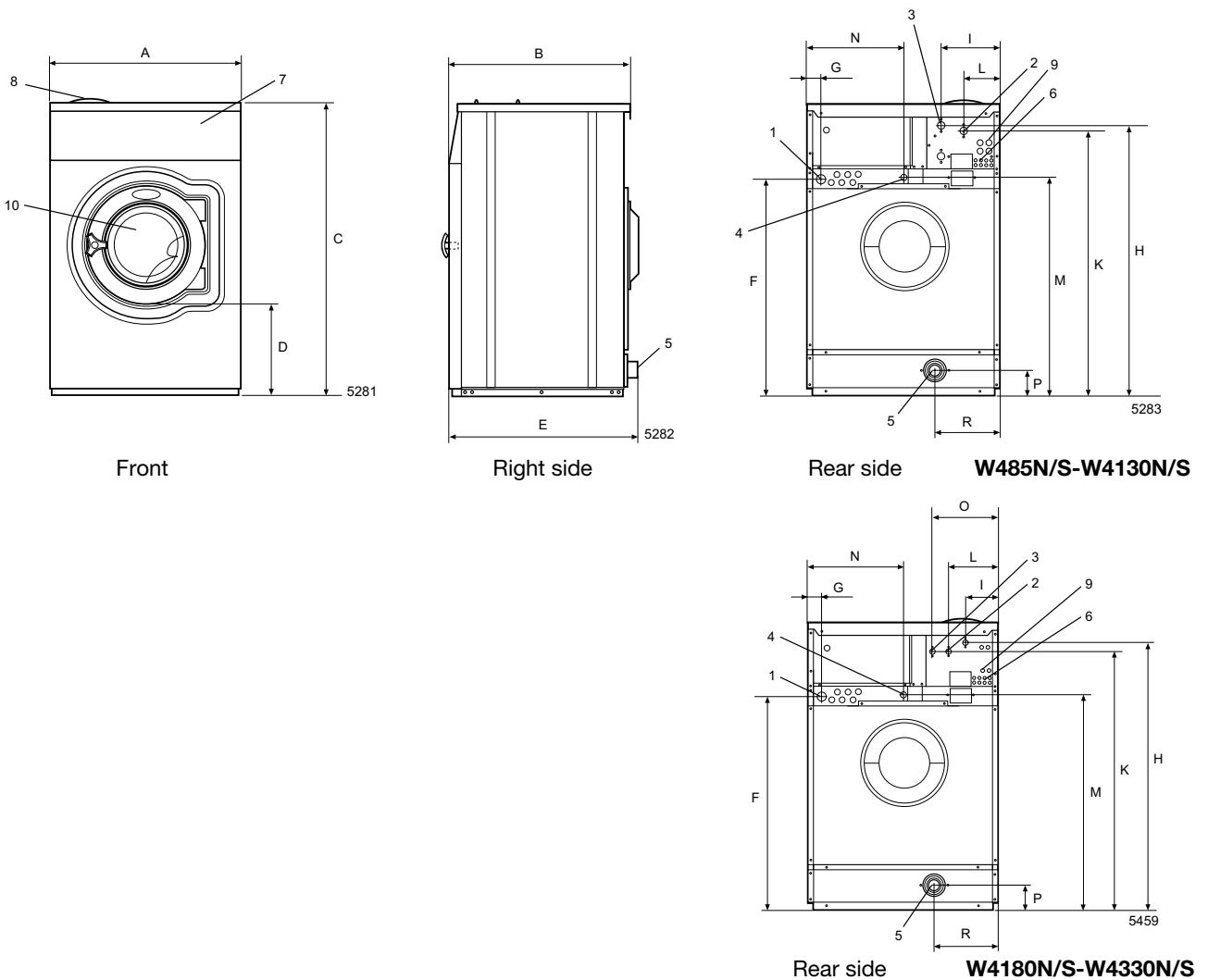

Technical data

in inch	A	B	C	D	E	F	G	H	I	K
W485N/S	26	28 3/4	43 7/8	14	30 1/8	32 1/2	1 3/4	40 9/16	8 7/16	39 3/4
W4105N/S	28 3/8	27 3/4	47 1/4	14 3/8	29 1/8	35 13/16	1 3/4	40 7/8	8 7/16	43 1/8
W4130N/S	28 3/8	31 1/8	47 1/4	14 3/8	32 1/2	35 13/16	1 3/4	40 7/8	8 7/16	43 1/8
W4180N/S	29 1/2	32 11/16	52 3/16	17 1/8	36	40 3/4	1 3/4	49	5 1/8	48 1/4
W4250N/S	32 11/16	37 5/8	55 1/2	17 1/8	39	44 1/8	1 3/4	52 3/8	6 5/16	50 13/16
W4330N/S	35 13/16	40 15/16	56 7/8	19 11/16	42 5/16	45 1/2	1 3/4	53 3/4	6 5/16	52 3/16

in inch	L	M	N	O	P	R
W485N/S	5 1/8	32 11/16	15 3/16	-	3 15/16	8 7/8
W4105N/S	5 1/8	35 13/16	19 9/16	-	3 15/16	9 1/4
W4130N/S	5 1/8	35 13/16	16 9/16	-	3 15/16	9 1/4
W4180N/S	8 1/4	40 15/16	12 13/16	11 5/8	3 15/16	8 7/8
W4250N/S	9 5/8	44 5/16	12 13/16	12 13/16	3 15/16	10 7/16
W4330N/S	9 5/8	45 1/2	11	12 13/16	3 15/16	8 1/4

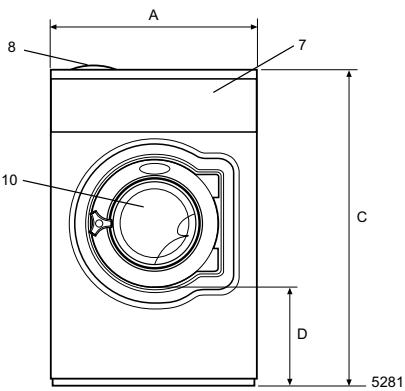

Front

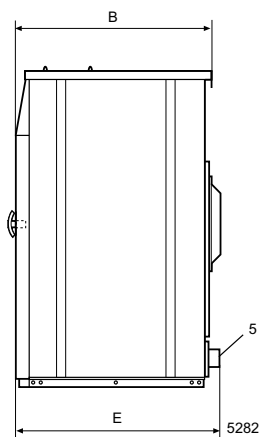

Right side

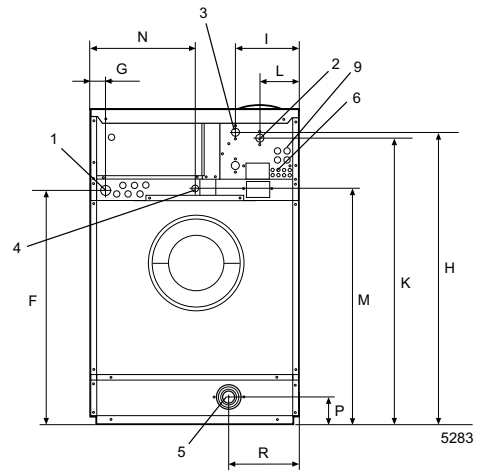

Rear side **W485N/S-W4130N/S**

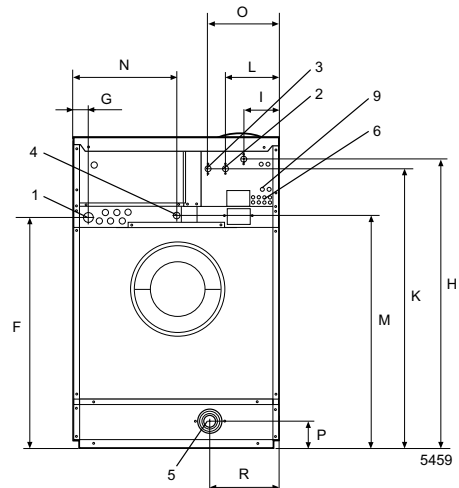

Rear side **W4180N/S-W4330N/S**

Technical data

	W475H	W4105H	W4130H	W4180H	W4240H	W4300H
Frequency of the dynamic force Hz	18.3	17.1	16.3	15.5	14.8	13.7
Max floor load at extraction lbs force kN	417±110 1.9±0.5	560±112 2.5±0.5	703±114 3.1±0.5	944±221 4.2±1.0	1158±221 5.2±1.0	1387±277 6.2±1.2

	W485N/S	W4105N/S	W4130N/S	W4180N/S	W4250N/S	W4330N/S
Frequency of the dynamic force Hz	9.3/13.8	8.7/12.9	8.7/12.9	8.3/12.3	7.9/11.7	7.5/11.2
Max floor load at extraction kN	1.7 ± 3.1/ 1.7 ± 2.6	2.1 ± 3.6/ 2.1 ± 3.0	2.3 ± 4.1/ 2.3 ± 3.7	2.9 ± 4.7/ 2.9 ± 4.6	3.7 ± 5.3/ 3.7 ± 5.8	4.5 ± 5.8/ 4.5 ± 6.8
lbs force	375±696/ 375±583	468±813/ 468±675	518±912/ 518±824	648±1057/ 648±1038	842±1189/ 842±1301	1019±1310/ 1019±1524

Installation W475H-W4330H

Transportation and unpacking, W475H, W4105H

The machine is delivered complete with expansion bolts etc. packed inside the machine in the drum.

The machine is delivered bolted onto the transport pallet and packed in a crate or box.

- Remove packing from the machine.
- Remove front and rear panel. Remove the bolts between the machine and pallet.
- Mount front and rear panel.
- Mount the feet.
- Place the machine on its final position.
- Level the machine with the feet of the machine.

- ① The machine also comes with transport safety devices (four plate angles between the frame and the drum).

In order to remove the safety devices:

- Unpack the machine.
- ② • Remove front and rear panel.
- Remove both front metal angels.
- Remove both rear metal angels.

NOTE!

Once the shipping safety devices have been removed, handle the machine carefully to avoid damage to the suspension components.

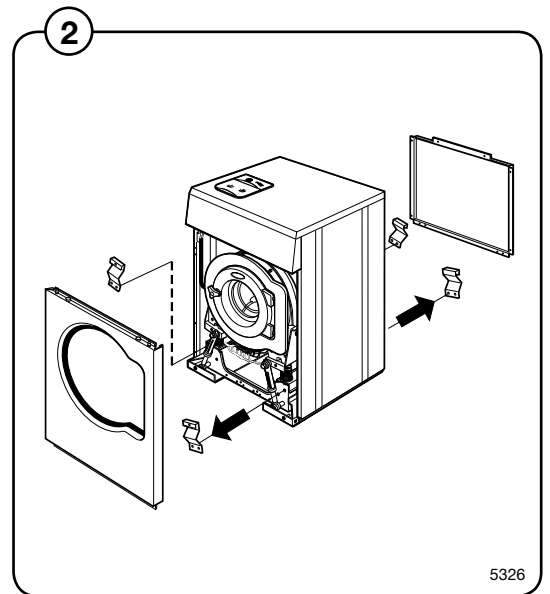
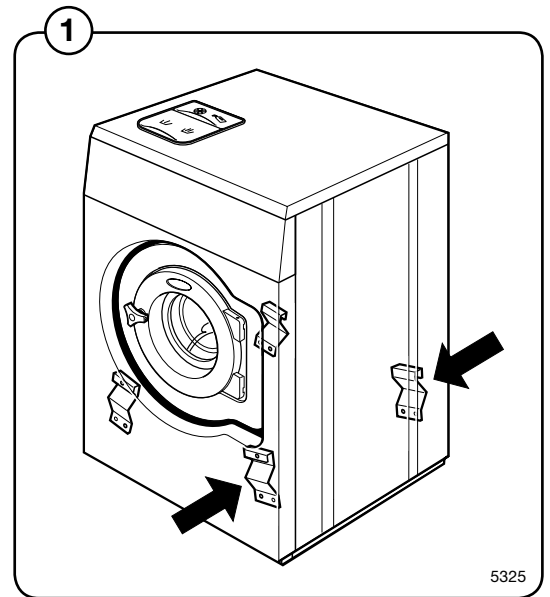

Transportation and unpacking, W4130H, W4180H, W4240H, W4300H

The machine is delivered complete with expansion bolts etc. packed inside the machine in the drum.

The machine is delivered bolted onto the transport pallet and packed in a crate or box.

- Remove packing from the machine.
- Remove front and rear panel. Remove the bolts between the machine and pallet.
- Mount front and rear panel.
- Mount the feet.

4

NOTE!

Regarding W4300H note the positioning of the two front feet.

- Place the machine on its final position.
- Level the machine with the feet of the machine.

3

The machine also comes with transport safety devices (two plate angles between the support and the drum).

In order to remove the safety devices:

- Unpack the machine.
- Remove the two side panels.
- Remove the two transport securities.

5

NOTE!

Once the shipping safety devices have been removed, handle the machine carefully to avoid damage to the suspension components.

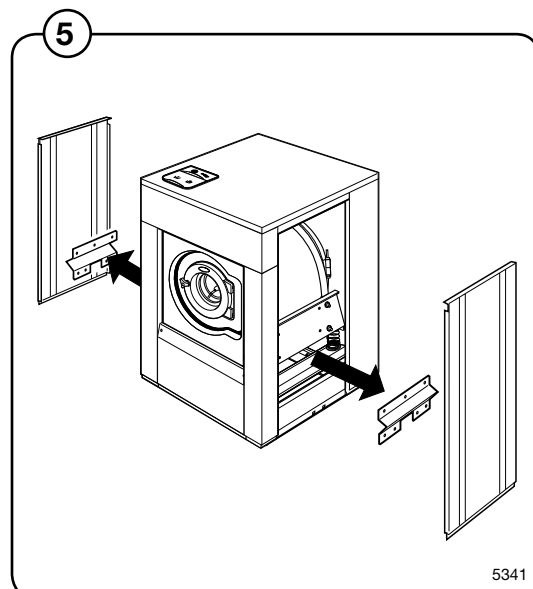
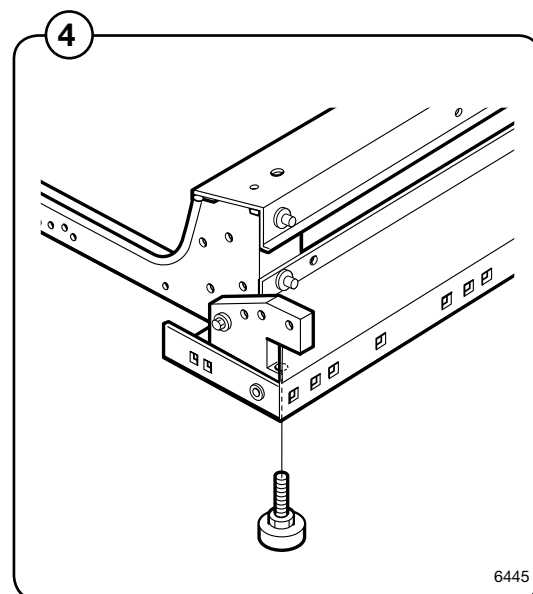
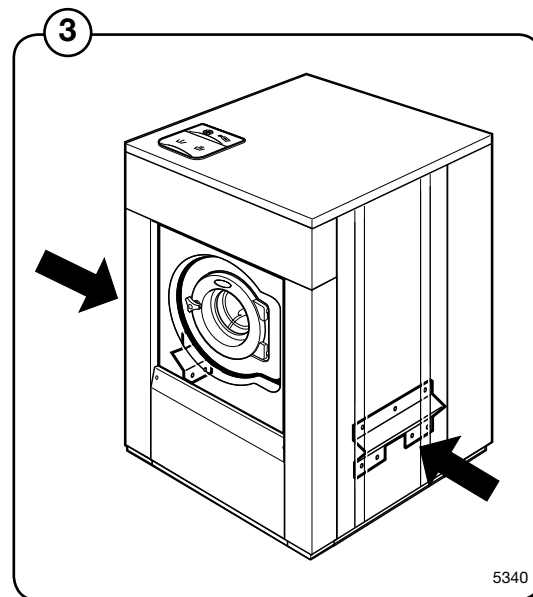

Siting and floor

Install the machine close to a floor drain or open drain.

- ⑥ In order to make installation and servicing the machine easier the following clearances are recommended:
- At least 20 inches (500 mm) between the machine and the wall behind
 - and min. 2 inches (50 mm) on both sides of the machine whether installed next to the wall or other machines.

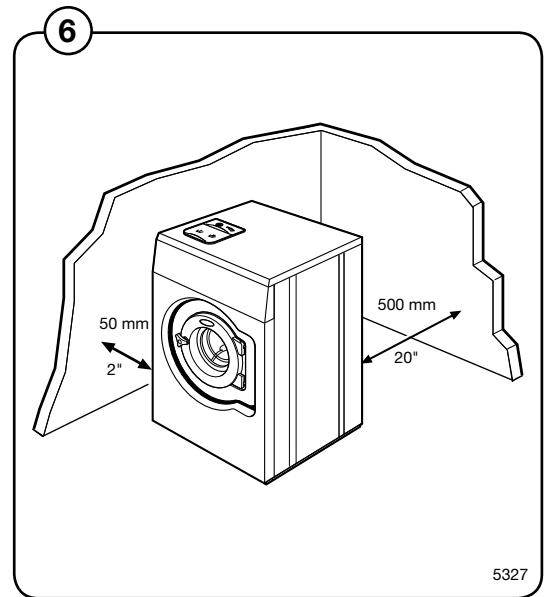

Mechanical installation

- 7 • Mark and drill 2 holes (ø 8 mm/5/16") about 40 mm/1 9/16" deep (W475H-W4105H) and ø 10 mm/3/8" and 50 mm/2" deep (W4130H-W4300H) in the positions.

● = position of feet

○ = drilling points for expander bolts

- The machine must be lifted in its base frame.
- Place the machine over the two drilled holes on the foundation.
- Check that the machine is in level, both side-to-side and front to back. Adjust with the feet.

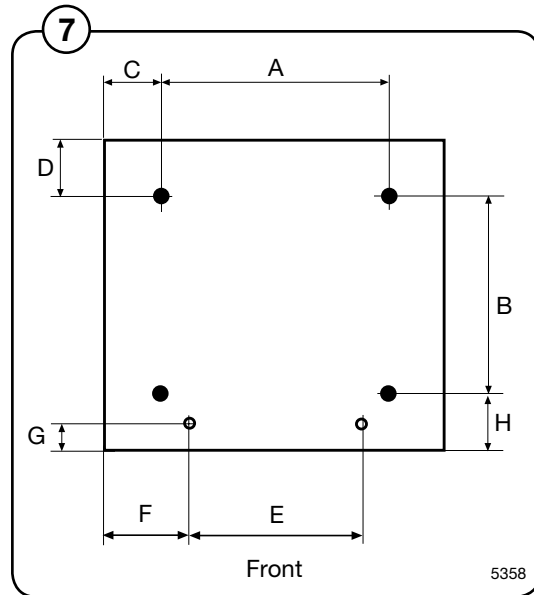

It is of utmost importance that the machine level, from side to side as well as front to rear. If the machine is not properly leveled, it may result in out-of-balance without a real out of balance in the drum.

- Insert the expansion bolts supplied in the holes drilled in the floor. Fit the washers and nuts, and tighten securely.

in mm	A	B	C	D	E	F	G	H
W475H	495	460	110	130	375	170	40	100
W4105H	575	465	130	140	455	185	35	95
W4130H	635	490	135	175	515	195	60	110
W4180H	715	545	125	205	595	185	60	115
W4240H	790	615	115	180	670	175	60	115
W4300H	790	755	60	180	670	175	60	75

in inch	A	B	C	D	E	F	G	H
W475H	19 1/2	18 1/8	4 5/16	5 1/8	14 3/4	6 11/16	1 9/16	3 15/16
W4105H	22 5/8	18 5/16	5 1/8	5 1/2	17 15/16	7 5/16	1 3/8	3 3/4
W4130H	25	19 5/16	5 5/16	6 7/8	20 1/4	7 11/16	2 3/8	4 5/16
W4180H	28 1/8	21 7/16	4 15/16	8 1/16	23 7/16	7 5/16	2 3/8	4 1/2
W4240H	31 1/8	24 3/16	4 1/2	7 1/16	26 3/8	6 7/8	2 3/8	4 1/2
W4300H	31 1/8	29 5/8	2 3/8	7 1/16	26 3/8	6 7/8	2 3/8	2 15/16

Installation W485N/S-W4330N/S

Leave the machine on the transport pallet until it can be placed in the final, prepared position.

Siting

Install the machine close to a floor drain or open drain. In order to make installation and servicing the machine easier the following clearances are recommended:

- ⑧ • At least 20 inches (500 mm) between the machine and the wall behind.
- Minimum 1 inch (25 mm) to next machine if more than one machine is installed on a foundation.

Floor

In this type of machine, the drum is attached directly to the frame. As a result the floor under the machine must be stable enough to absorb the dynamic forces generated during spin cycles. For that reason, the mounting bolts must be cast into the floor material itself.

The machine must be securely fastened to a suitable foundation using M16 (5/8 inch) threaded rod, flat washers and lock nuts or lock washers. Failure to properly secure the machine to its foundation, or securing the machine to an inadequate foundation, will result in severe vibration, damage to the machine, and will void the manufacturer's warranty.

When fixing the machine to an existing cement floor, it must be at least 8 inches (200 mm) thick.

The floor must be able to withstand the loads indicated in the table.

If it isn't possible to cast the bolts into the floor, an alternative might be to use so-called chemical anchors. Your local dealer can provide the information you need.

IMPORTANT NOTE:

The use of chemical anchors and/or the use of a fabricated steel mounting base DOES NOT reduce the thickness requirement for the underlying concrete floor. The floor MUST BE AT LEAST 8 INCHES (200 MM) THICK, or a new concrete foundation MUST be poured.

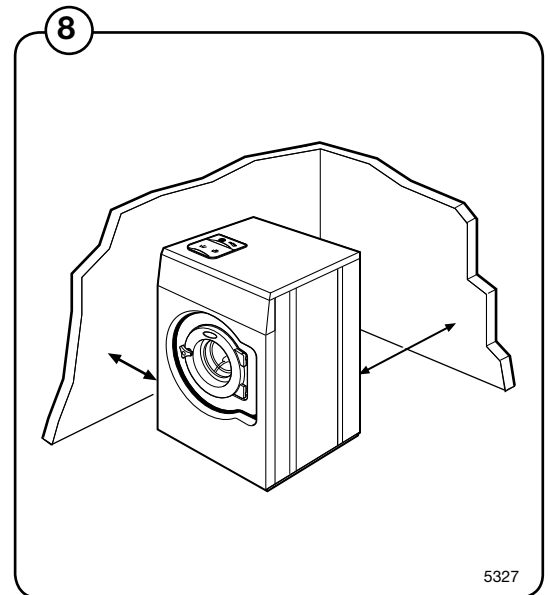

Casting a plinth

- 9 A foundation should be used where the existing floor is less than 8 inches (200 mm) thick or in order to ensure that the machine is securely anchored and will not vibrate excessively.

The foundation must be at least 8 inches (200 mm) thick.

Proceed as follows:

- 10
- Break up the existing floor to a depth of approx. 5 inches (125 mm) and check that the sides of the hole are tapered outward so that the longest side at the bottom measures 5 inches (125 mm) more than at the top.
 - Make the forms for the foundation.
 - Moisten the hole well and apply cement to the sides and bottom.
 - A number of mounting bolts must be set into the concrete of the foundation. The bolts need to project 1-1 1/2 inches (40 mm) out of the base. Pour the concrete into the prepared base mold and make sure that the surface is level.
 - The concrete should be left to set for at least two days before mounting the machine on the foundation.
 - Mounting bolt locations are shown with respect to the outer surface of the machine's front panel. If the front panel is to be set back from the front of the foundation, add the set-back distance to dimension "E".

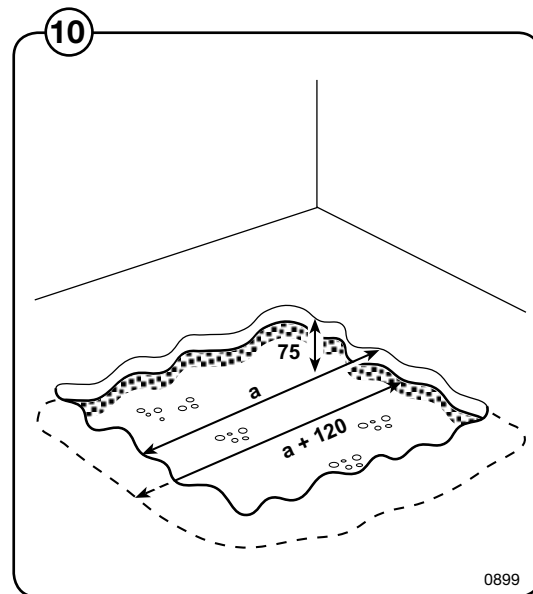
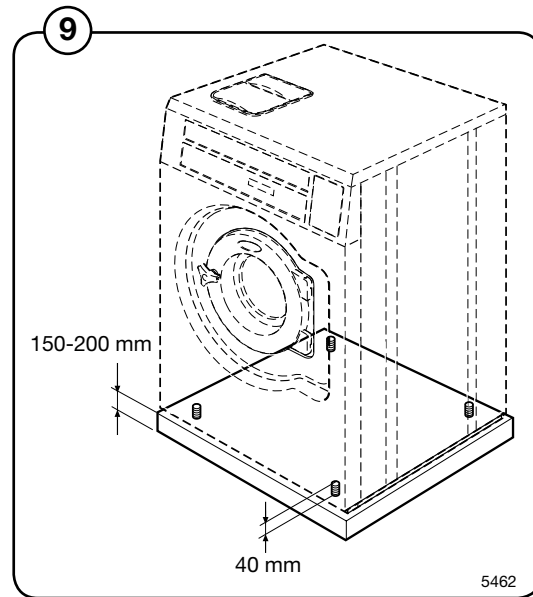

Model W4330S

For this machine two expander bolts shall be mounted at the front part of the machine.

- ⑪
- Drill two holes (1) $\varnothing 10$ mm/ 3/8" and 40 mm/ 1 9/16" deep.
 - After the machine has been placed over the other four bolts, place the two spacer washers over the two holes. They shall be placed between the machine and foundation.
 - Mount the expanderbolts in the drilled holes and fasten the machine. Don't forget the washers.

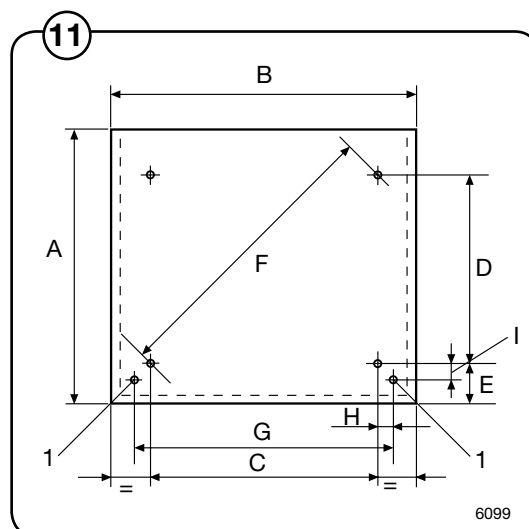

in mm	A	B	C	D	E	F	G	H	I
W485N	725	660	495	445	115	665	-	-	-
W4105N	700	720	575	385	120	695	-	-	-
W4130N	785	720	575	495	120	760	-	-	-
W4180N	875	750	635	570	120	855	-	-	-
W4250N	950	830	715	635	125	955	-	-	-
W4330N	1035	910	790	695	135	1050	810	10	95
W485S	725	660	495	445	115	665	495	0	75
W4105S	700	720	575	385	120	695	595	10	80
W4130S	785	720	575	495	120	760	595	10	80
W4180S	875	750	635	570	120	855	655	10	85
W4250S	950	830	715	635	125	955	735	10	85
W4330S	1035	910	790	695	135	1050	810	10	95

in inch	A	B	C	D	E	F	G	H	I
W485N	28 9/16	26	19 1/2	17 1/2	4 1/2	26 3/16	-	-	-
W4105N	27 7/8	28 3/8	22 3/4	15 3/16	4 3/4	27 13/32	-	-	-
W4130N	30 7/8	28 3/8	22 5/8	19 1/2	4 3/4	29 15/16	-	-	-
W4180N	34 7/16	29 1/2	25	22 7/16	4 3/4	33 11/16	-	-	-
W4250N	37 3/8	32 11/16	28 1/8	25	4 15/16	37 5/8	-	-	-
W4330N	40 3/4	35 13/16	31 1/8	27 3/8	5 5/16	41 5/16	31 7/8	13/32	3 3/4
W485S	28 9/16	26	19 1/2	17 1/2	4 1/2	26 3/16	19 1/2	0	2 15/16
W4105S	27 7/8	28 3/8	22 3/4	15 3/16	4 3/4	27 13/32	23 7/16	13/32	3 1/8
W4130S	30 7/8	28 3/8	22 5/8	19 1/2	4 3/4	29 15/16	23 7/16	13/32	3 1/8
W4180S	34 7/16	29 1/2	25	22 7/16	4 3/4	33 11/16	25 13/16	13/32	3 3/8
W4250S	37 3/8	32 11/16	28 1/8	25	4 15/16	37 5/8	28 15/16	13/32	3 3/8
W4330S	40 3/4	35 13/16	31 1/8	27 3/8	5 5/16	41 5/16	31 7/8	13/32	3 3/4

Installing the machine

To install the machine:

- Remove the transport packaging
- Remove the front panel.
- Remove the machine from the transport pallet and locate it on the bolts.
Always lift the machine by the chassis, never by the door or door handle.
- ⑫ • Check that the machine is level and steady at all four corner mounting points. Adjust the level by using stainless or galvanized steel washers or shims between the machine and the floor. The washers must be of a size to cover the support surface.
- ⑬ • Fit the washers and self-locking nuts supplied with the machine and tighten securely.
- ⑭ • To tighten the nuts we recommend to use a ratchet wrench, especially in the right rear corner.

During the first several weeks of use, check and tighten the nuts (as necessary) frequently. Continue to check them periodically, thereafter.

IMPORTANT NOTE:

Failure to closely follow the instructions provided in this manual may result in severe damage to the machine, and the risk of personal injury. The manufacturer is not responsible for damage or injury resulting from improper installation.

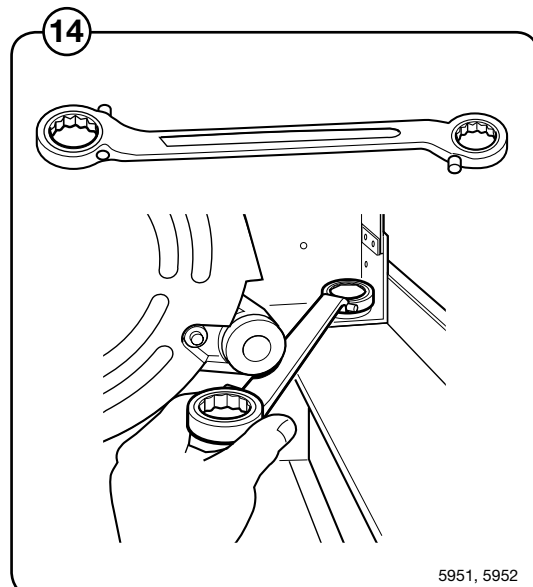
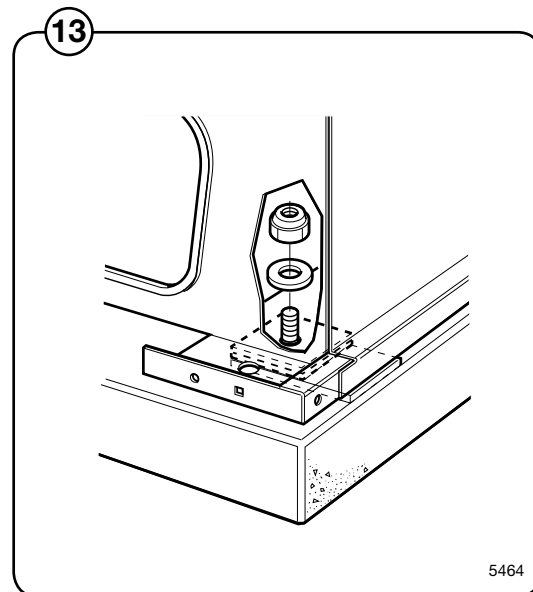
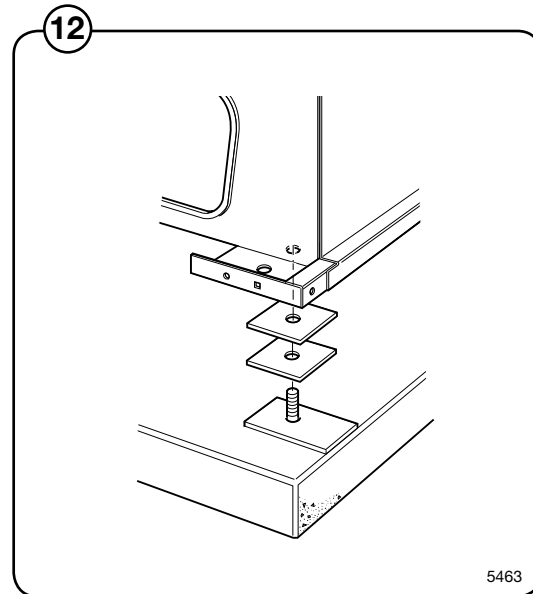

Water connections

All inlet connections to the machine are to be fitted with manual shut-off valves and filters, to facilitate installation and servicing.

Water pipes and hoses should be flushed clean before installation. After installation, hoses should hang in gentle arcs.

Hoses are to be of an approved type and grade, to comply with national regulations.

The machine may have between one and four DN 20 (R 3/4") water connectors. **All connectors present on the machine must be connected to the water supply, or the machine may not function properly.** The table shows the possible connection options, which will depend on the model of the machine.

All water connectors must be connected up, otherwise the wash program will not function correctly.

The water pressure data is as follows:

- min: 15 PSI (100 kPa)
- max: 90 PSI (600 kPa)
- recommended: 30-90 PSI (200-600 kPa)



If the water pressure is below the min. value, the wash result can not be guaranteed for certain program.

	Water type	Water connection		
		1	2	3
15	cold and hot	cold	hot	
16	cold and hot	cold	hot	cold*/hot

* For detergent container.

Extra water valve which can be used for hard water if soft water is connected to 1.

This valve can also be used for water reuse from tank.

If pump is used, it is only a water connection without valve.

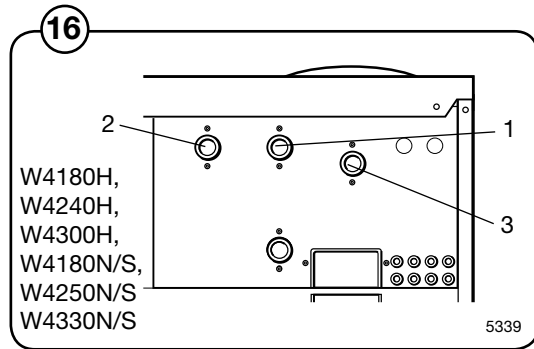
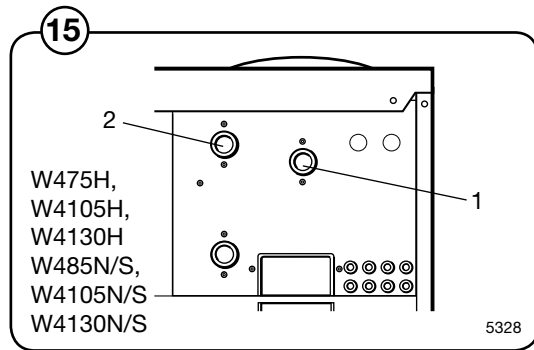

Drain connection

Connect a 3 inch O.D. (75 mm) pipe or rubber hose to the machine's drain pipe, ensuring a downward flow from the machine. Avoid sharp bends which may prevent proper draining.

- ①7 The washer may drain in to a drainage through or into a closed drain system. In either case, be sure to comply with all applicable national and local plumbing code provisions.

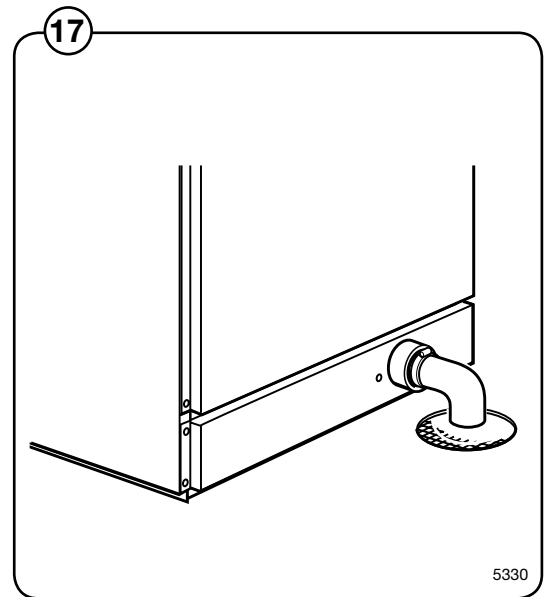

5330

Steam connection

Inlet pipes connected to the machine must be equipped with a manual shut-off valve to facilitate installation and servicing.

The connection hose must be of type ISO/1307-1983 or equivalent. Connection size at filter: DN 15 (BSP 1/2").



Steam pressure required:

- minimum: 7 psi (50 kPa)
- maximum: 115 psi (800 kPa)
- rec. pressure: 600 kPa (6 kp/cm²)

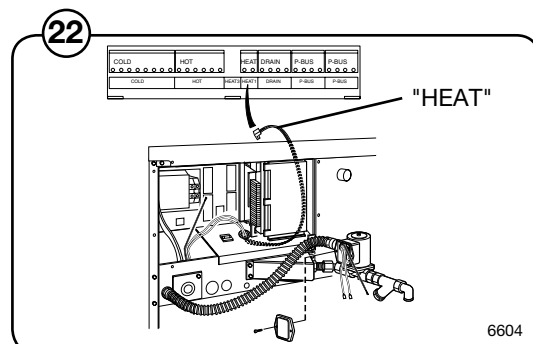
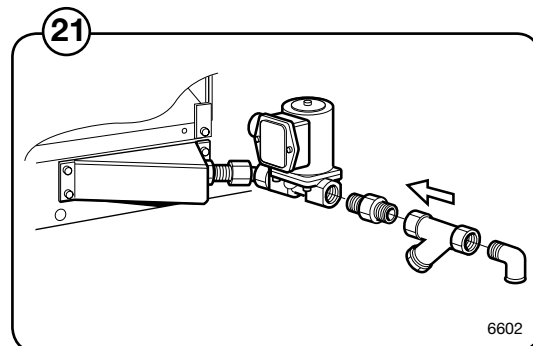
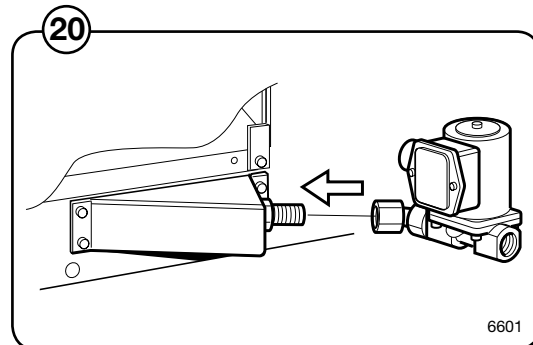
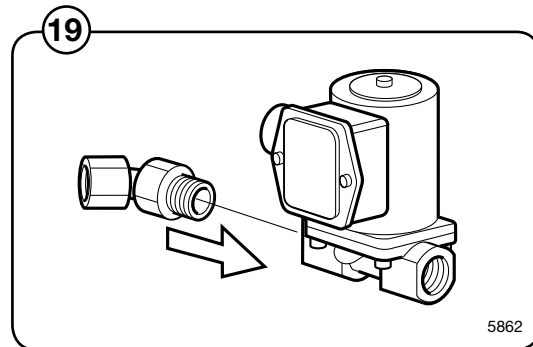
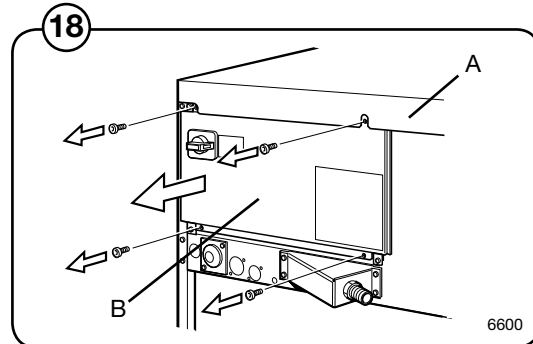
- 18 • Remove top cover (A).
- Remove casing (B).
- 19 • Mount the articulated nipple to the steam valve.
- Mount the steam valve on the machine.
- 20 • Mount nipple, strainer and elbow. Note the direction of the strainer. Mount steam hose to the elbow. Check that there are no sharp angles or bends on the connected steam hose.
- 21 • Mount the hose with wires between steam valve and machine. Connect wires in the steam valve. Connect ground cable to the terminal ground connection.
- 22 • Connect the "HEAT" cable connector to the "HEAT" terminal on the I/O board.



Connection of external liquid supplies

The external dosing equipment power supply must never be connected to the machine's incoming terminal block.

Machines fitted with connectors

- 23
- Connect the pump equipment to connections A and B on the washing machine. Connect the signal cable to B and the power supply to A.

Machines without connectors

- Connect the external pump equipment for liquid washing detergent to the I/O board, which is located to the right of the incoming power supply. The I/O card has edge connectors for connecting external pumps.
- 24
- Edge connectors on the I/O board can be loosened for connecting cables.

- 11 = N
- 18 = Program run
- 12 = Signal 1
- 13 = Signal 2
- 14 = Signal 3
- 15 = Signal 4
- 16 = Signal 5

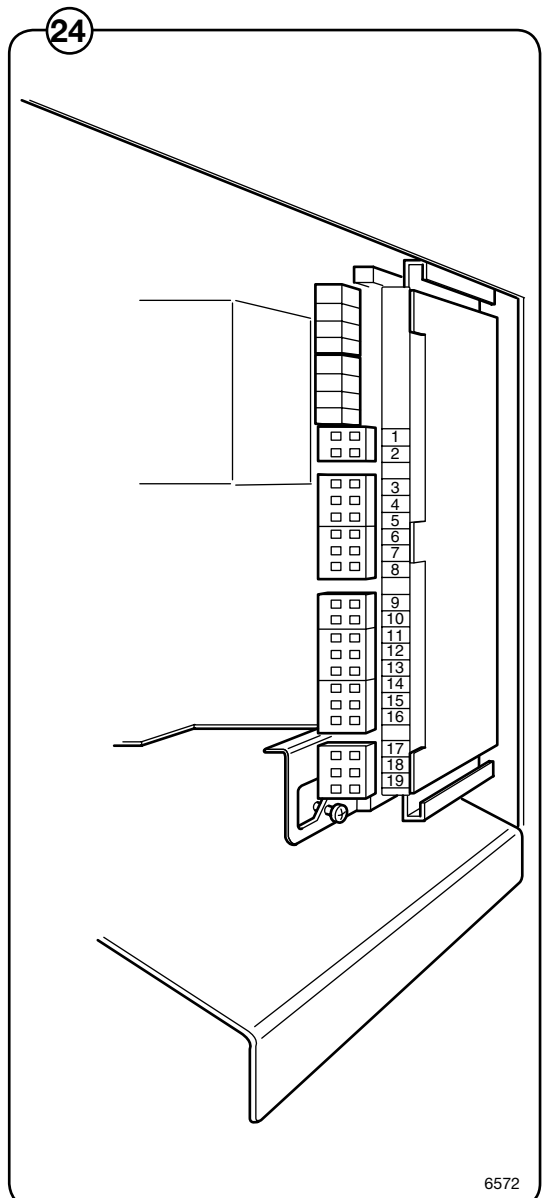
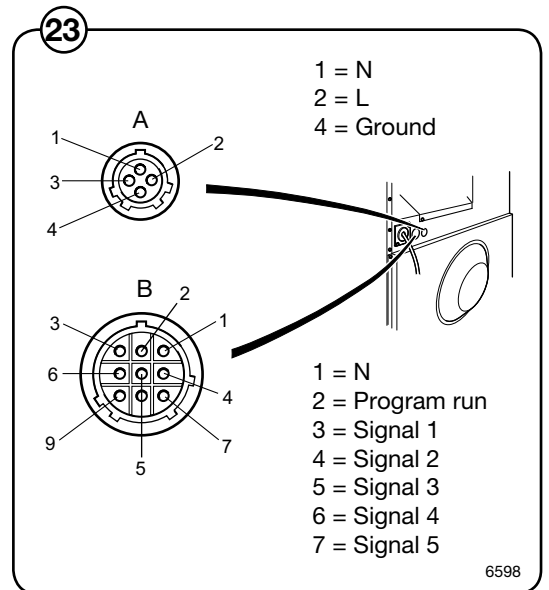

Outputs

- 25

 - Connect external power supply (e.g. 24V DC) for pumps to 9 and 10. If an internal power supply (from the washing machine) is being used, it can be taken from 1 (N) and connected to 9 and from 2 (L) and connected to 10. Max load on the outputs 0.5 A.
- 26

 - Signals for pumps 1-5 are connected to 12-16 where connector

12	Washing detergent signal 1
13	Washing detergent signal 2
14	Washing detergent signal 3
15	Washing detergent signal 4
16	Washing detergent signal 5

Inputs

- The signal level can be 5-24V DC/AC or 100-240V AC. For 5-24V, the signal reference is connected to 3 and for 100-240V to 4. Potentials on the inputs cannot be mixed. NB! The I/O board will be damaged if the voltage on connection 3 is too high, >24V.

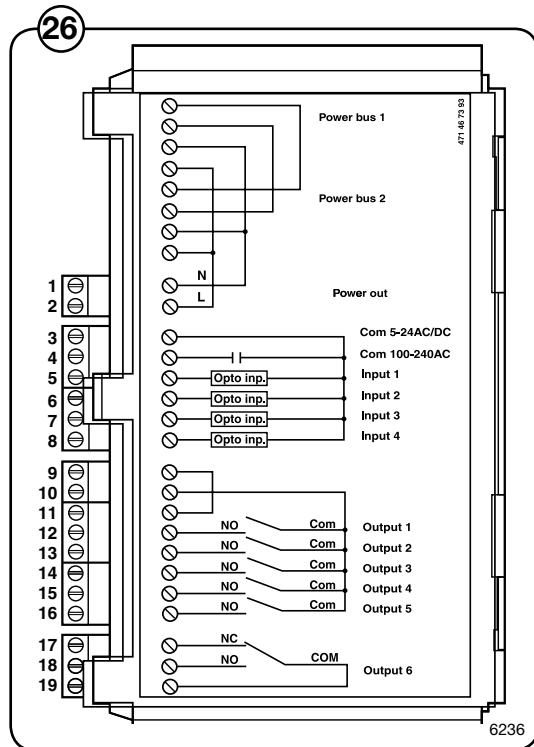
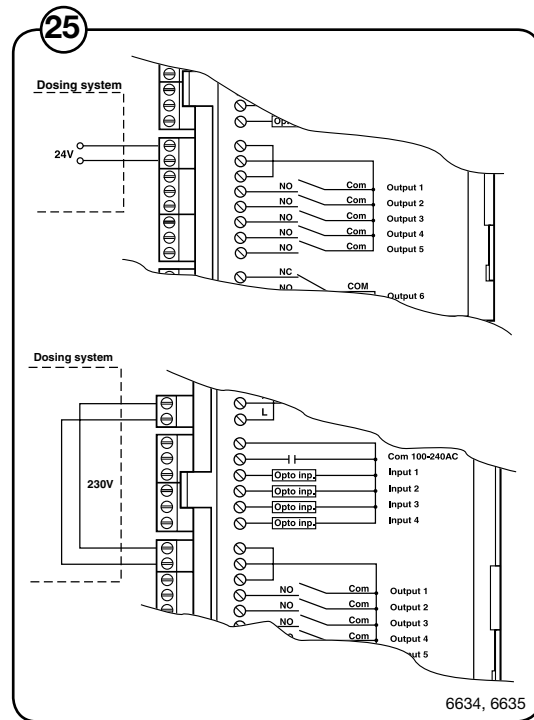

- 27 • Connection 8 may be connected if the washing program is to pause, e.g. while washing detergent is being dosed.
The figure shows an example of engaging a 24V pause signal.
The washing program will pause for as long as the pause signal remains activated (high).

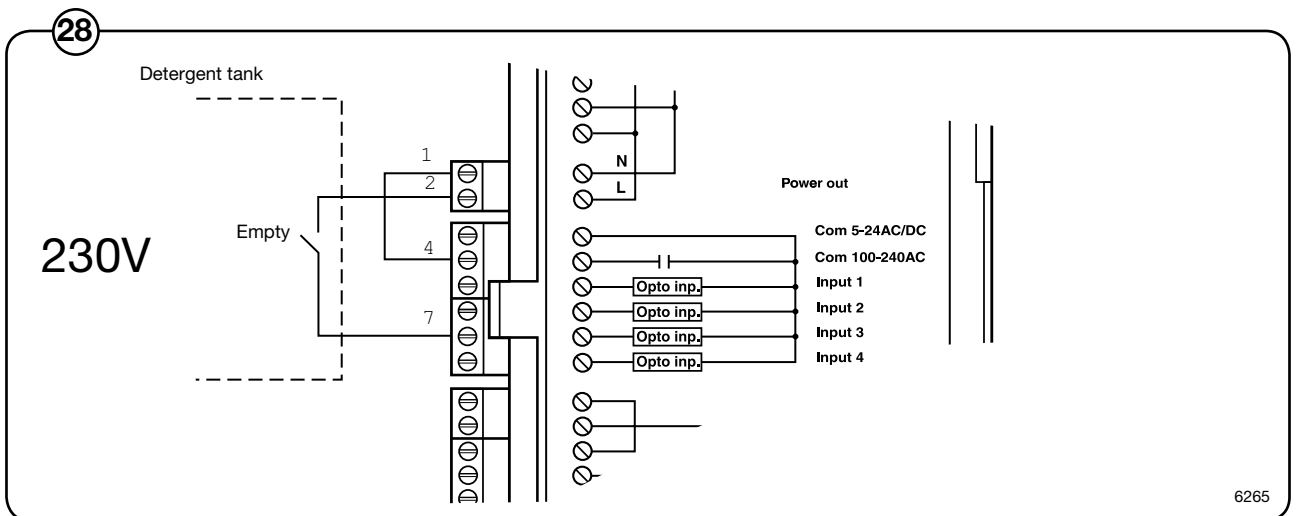
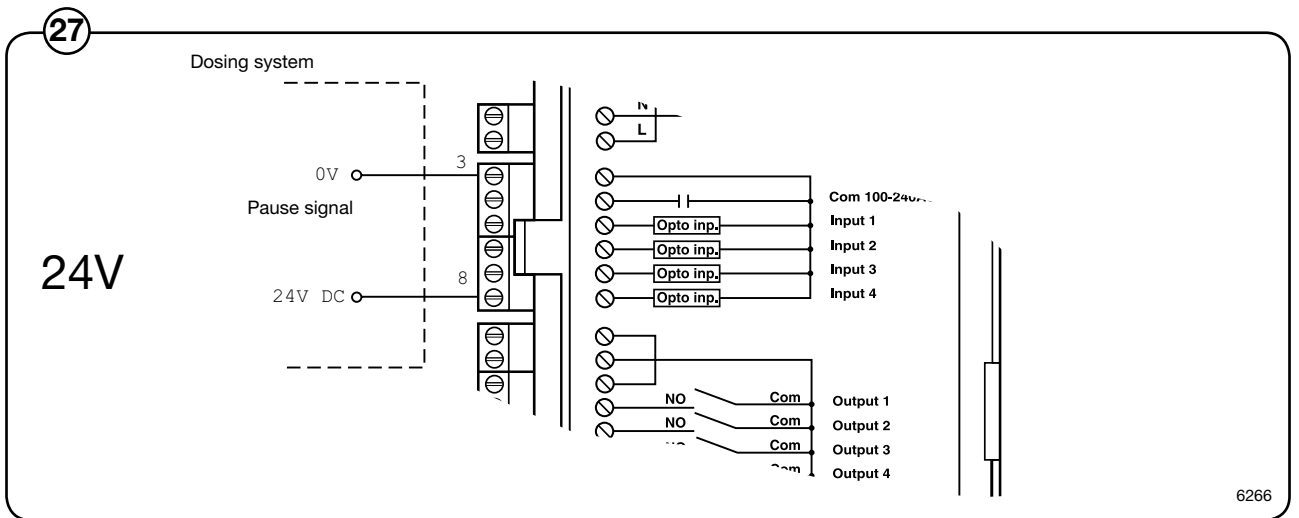

- 28 • Connection 7. If this is connected, an error message will be displayed indicating that one of the chemical tanks is empty. The washing program will continue, however.
The figure shows an example of engaging a normal open contact.
- 29 • Connect the liquid dosing hoses to any of the connections marked A.

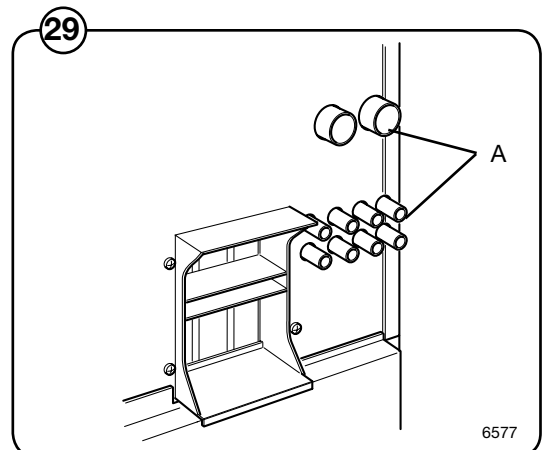

Functions for I/O -cards

- Check the electrical schematic for the machine to find out what functions are available for the machine.

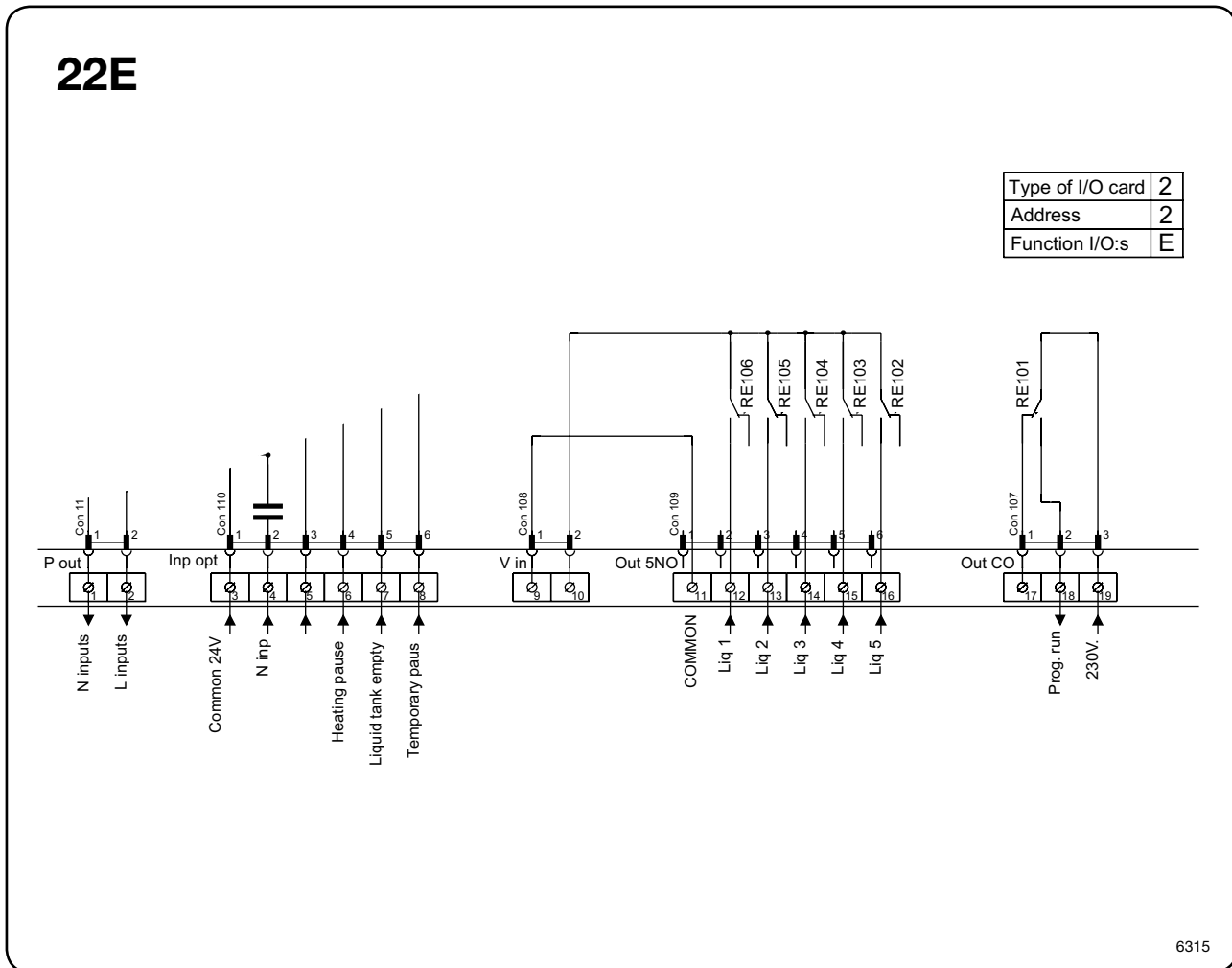

6315

- Heating pause: Signal can be connected to connection 6 to pause the machine whilst it heats up. The machine’s heating program will pause for as long as the pause signal remains activated (high).

Electrical installation



Electrical installation must be carried out by licensed, qualified personnel!



Machines with frequency-controlled motors can be incompatible with certain types of earth leakage circuit breakers. It is important to know that the machines are designed to provide a high level of personal safety, which is why items such as ground-fault interrupting circuit breakers are not necessary. If you still want to connect your machine across ground fault circuit breaker, please remember the following:

- **contact a licensed, qualified electrician to ensure that the appropriate type of breaker is chosen and that the breaker rating is correct**
- **for maximum reliability, connect only one machine per circuit breaker**
- **it is important that the earth wire is properly connected, including to the ground fault circuit breaker.**

An individual electrical disconnect must be provided in proximity to each machine.

The connecting cable should hang in a gentle curve.

For proper circuit breaker sizes, see table on the next page.

Single-phase connection:

- 30 Connect the earth and other two wires as shown in example "1AC" in the figure.

Three-phase connection:

- 31 Connect the earth and the three phases as shown in example "3AC" in the figure.

When the installation is completed, check:

- that the drum is empty.
- that the machine operates by turning on the mains switch, starting the machine and using RAPID ADVANCE to reach the spin cycle (see operations manual).

**IMPORTANT**

When making power supply connections to machines rated 208-240V AC, do not connect any phase measuring in excess of 125 V AC (with respect to earth ground) to the L1 or L2 terminals on the connection block. So-called "stinger legs" must be connected to the "L3" terminal, which does not feed power to the control circuits of the machine.

On three-phase models (except W4330S), check that the drum rotates in the direction indicated on the machine while in extraction. If the direction is incorrect, reverse two of the power line phases to correct the rotation direction, while observing the note above.

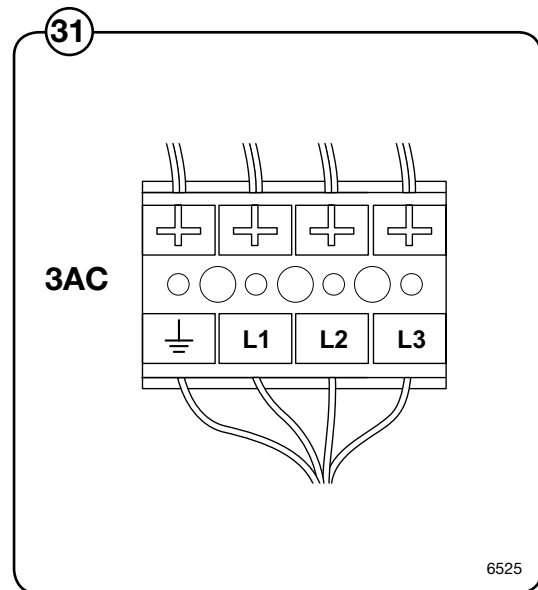
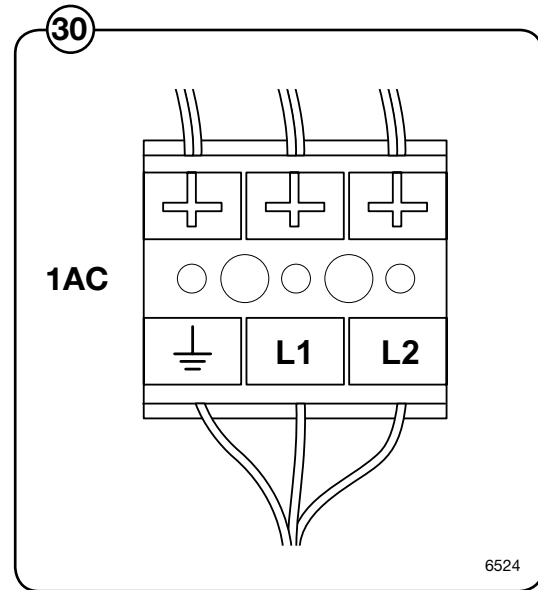

W475H

Heating alternative	Voltage alternative	Total kW	Fuse A
No heating or Steam heating	100-120 V 1 AC	1.1	15
	208-240 V 1 AC	1.1	10
El heating	220-230 V 3 AC	7.0	20

W4105H

Heating alternative	Voltage alternative	Total kW	Fuse A
No heating or Steam heating	208-240 V 1 AC	1.3	15
El heating	208-240 V 3 AC	9.2	30

W4130H

Heating alternative	Voltage alternative	Total kW	Fuse A
No heating or Steam heating	208-240 V 1 AC	1.6	15
El heating	208-240 V 1 AC	12.5	66
	208-240 V 3 AC	11.8	35
	440/480 V 3 AC	13.5	20

W4180H

Heating alternative	Voltage alternative	Total kW	Fuse A
No heating or Steam heating	208-240 V 1 AC	2.3	15
El heating	208-240 V 3 AC	17.5	60

W4240H

Heating alternative	Voltage alternative	Total kW	Fuse A
No heating or Steam heating	208-240 V 1 AC	2.6	15
El heating	208-240 V 3 AC	18.3	63

W4300H

Heating alternative	Voltage alternative	Total kW	Fuse A
No heating or Steam heating	208-240 V 1 AC	2.1	15
El heating	208-240 V 3 AC	20.9	60

W485N/S

Heating alternative	Voltage alternative	Total kW	Fuse A
No heating or Steam heating	120 V 1 AC	0.5	15
	208-240 V 1 AC	0.5	15
El heating	208-240 V 3 AC	7.3	30

W4105N/S

Heating alternative	Voltage alternative	Total kW	Fuse A
No heating or Steam heating	120 V 1 AC	0.75	15
	208-240 V 1 AC	0.75	15
El heating	208-240 V 3 AC	9.2	30

W4130N/S

Heating alternative	Voltage alternative	Total kW	Fuse A
No heating or Steam heating	120 V 1 AC	0.8	15
	208-240 V 1 AC	0.8	15
El heating	208-240 V 3 AC	9.3	30

W4180N/S

Heating alternative	Voltage alternative	Total kW	Fuse A
No heating or Steam heating	120 V 1 AC	1	15
	208-240 V 1 AC	1	15
EI heating	208-240 V 1 AC	12.1	60
	208-240 V 3 AC	12.7	50

W4250N/S

Heating alternative	Voltage alternative	Total kW	Fuse A
No heating or Steam heating	120 V 1 AC	1.4	20
	208-240 V 1 AC	1.4	15
EI heating	208-240 V 3 AC	12.1	60

W4330N/S

Heating alternative	Voltage alternative	Total kW	Fuse A
No heating or Steam heating	120 V 1 AC	1.6	20
	208-240 V 1 AC	1.6	15
EI heating	208-230 V 3 AC	19.7	60

Function checks

Perform the following checks once the machine is installed:

- Open the manual water valves.
- Turn on the power to the machine.
- Put detergent into compartment 2 (Main wash).

① • Select a "HOT" program with the control knob (1).

② • Press the knob.

Check:

- that the drum rotates normally and that there are no unusual noises.
- that there are no leaks in water supply/drain connections.
- that water passes through the detergent compartment and fabric conditioner compartment.
- that the door cannot be opened during a program.

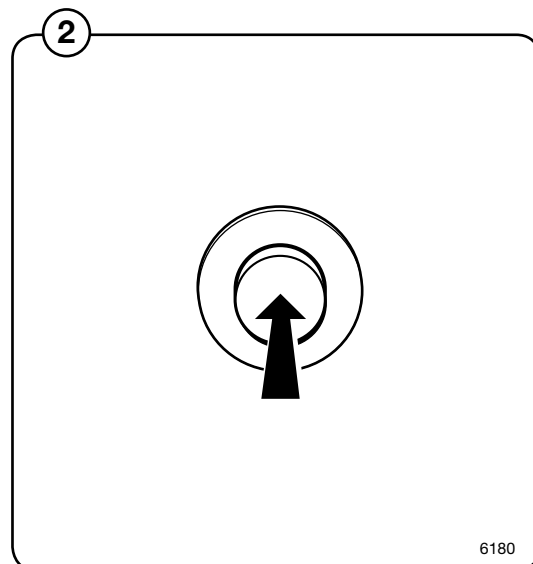
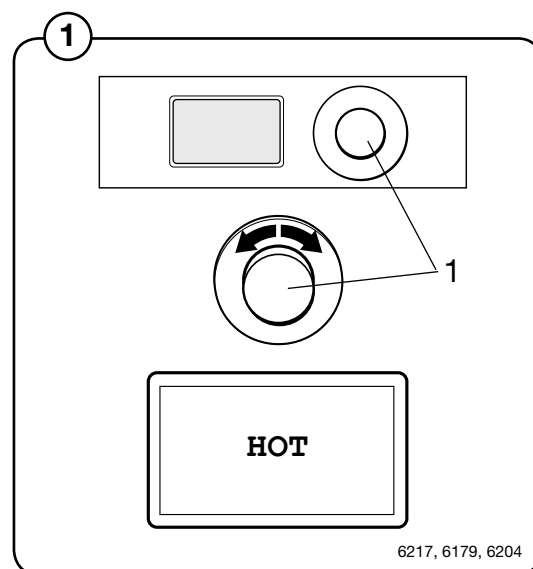

Thinking of you
 **Electrolux**

www.electrolux.com/laundrysystems

Share more of our thinking at www.electrolux.com